



VANAUKER COMPANIES

OFFICE AND WAREHOUSE SPACE FOR LEASE



GENERAL INFORMATION

ADDRESS:	1910 Madison Ave Nampa, ID	BUILDING SIZE:	22,500 Square Feet 12,000 SF AVAILABLE
CONTACT:	Ron Van Auker, Jr	ZONING:	I-L (Light Industrial)
PHONE:	(208) 887-7994	YEAR BUILT:	1996
FAX:	(208) 887-7998		
EMAIL:	ron@vanauker.com		

COMMENTS

- 12,000 sq.ft. available. Divisible to (2), 6,000 sq.ft. suites
- 2,000 sq.ft. offices built out in southeast corner of building.
- Site has excellent freeway access to I-84 via Franklin Blvd. or Sugar Factory exit.
- Dock high and grade level doors.



VANAUKER

COMPANIES

Area Map





VANAUKER COMPANIES

Close-up aerial photo





VANAUKER

COMPANIES

Floor Plan

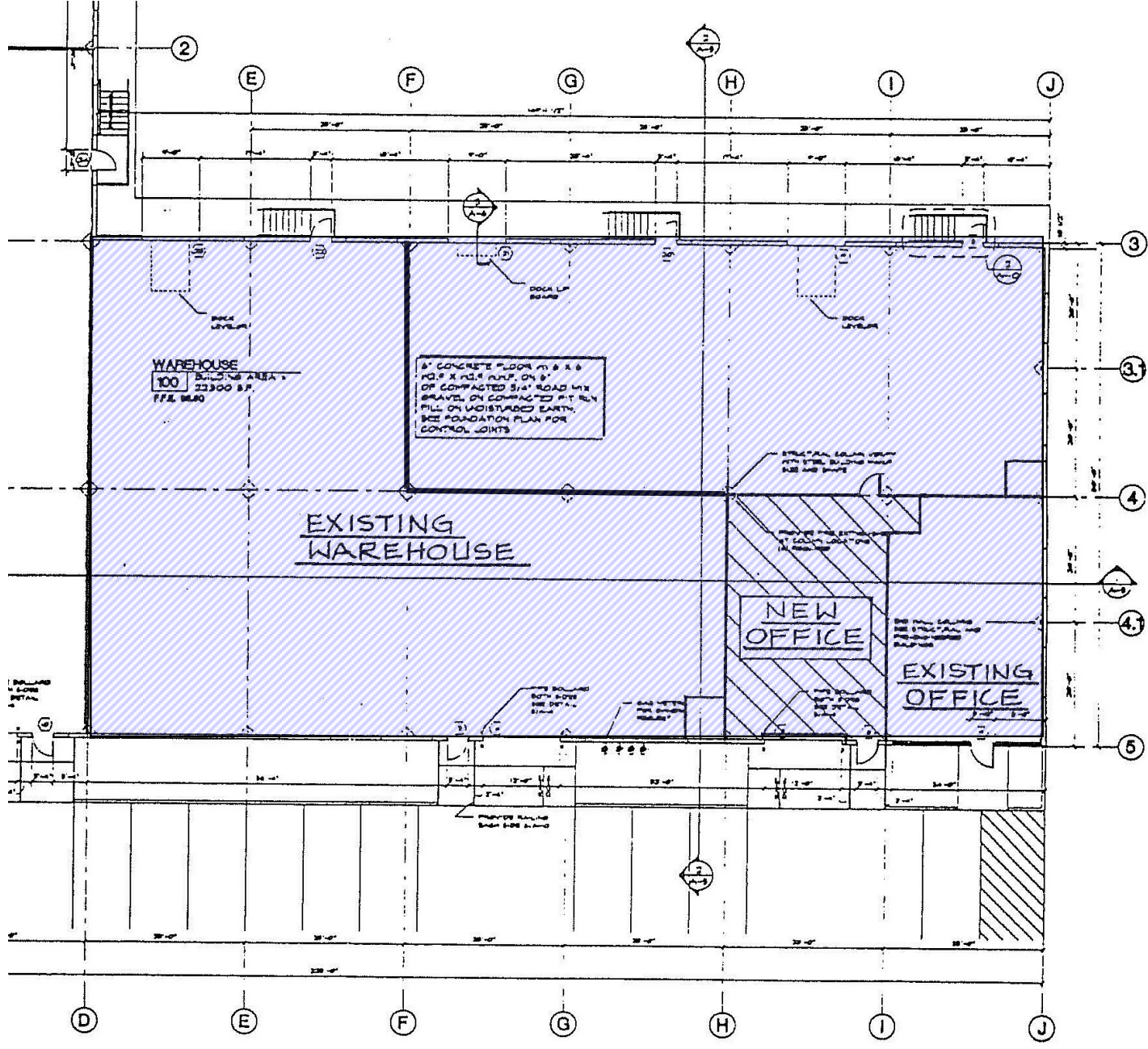

PLAN - BUILDING #3